



ITR10.16T
TELESCOPIC



ITRunner



www.itrunner.it

2 AXLES HOOKLIFT TRAILER ITR 10.16 T TELESCOPIC MECHANIC SUSPENSIONS

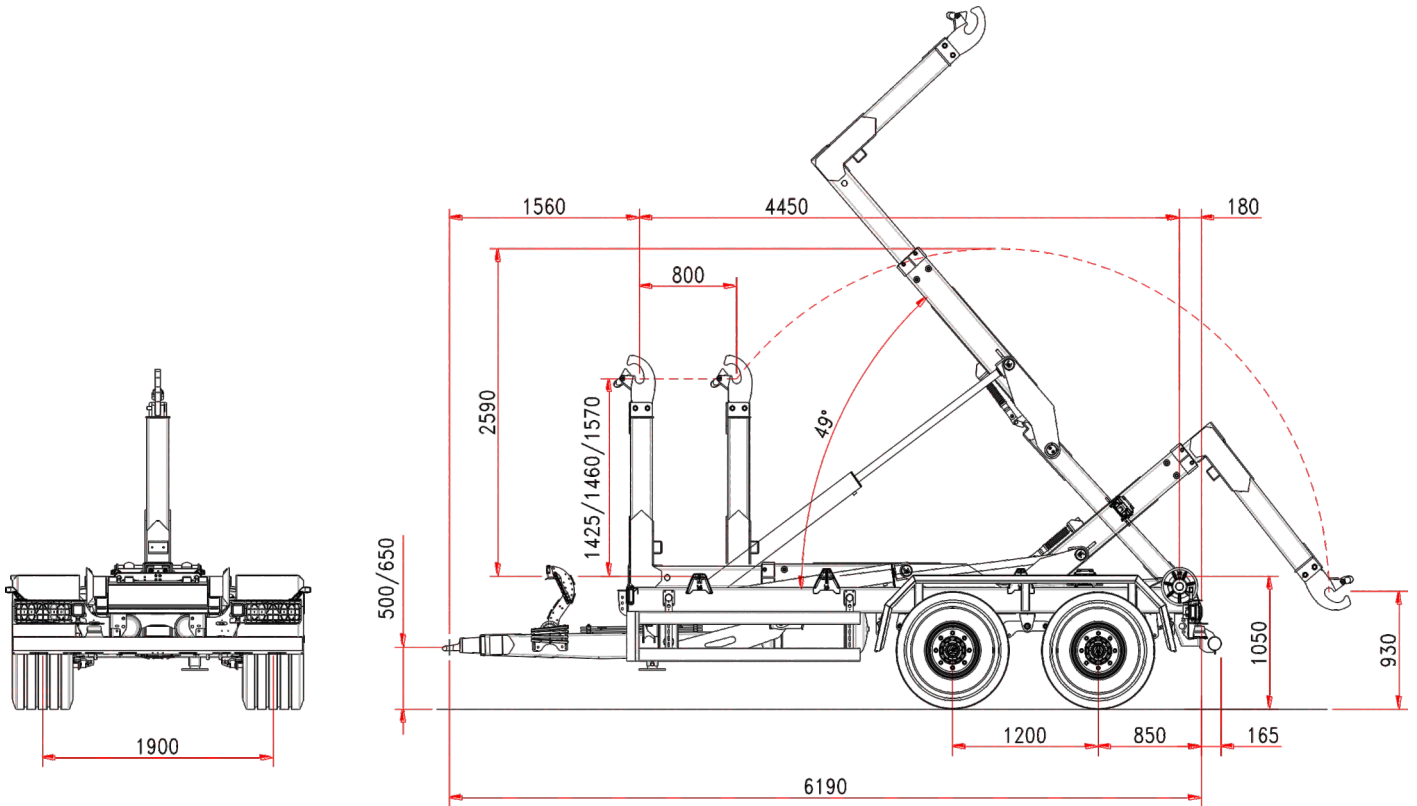

Standard Features

CHASSIS

Frame section	200 x 100 mm
Draw bar	silent blocks
Leaf spring suspension	16 t
Axles wheelbase	1200 mm
Axles section	2 x 100 mm
Axles	fixed + fixed
Track	1900 mm
Brake drums	350 x 90 mm
Braking system	hydraulic
Towing eye	turning
Support foot	hydraulic
Wheel size	500/50-17
Chassis loading level	1050 mm

WEIGHT AND DIMENSION

Gross Trailer Weight (G.T.W.)	16 t
Container handling cap.	3500/5500 mm
Max speed	40 km/h
(*) Tare	3500 kg

TELESCOPIC ARM

Run	800 mm
Hook level	1425/1460/1570
Container internal/external	hydraulic
locking	49°
Tipping angle	10 t
Tipping capacity	10 t

OLEO-DYNAMIC SYSTEM

Tractor hydraulics	3 controls d.a.
Oil volume (hooklift filled)	30 l
Hooklift filled:	
Cylinders oil operation	
demand	6,8 l
Tipping	7,4 l
Loading/unloading	

(*) Tare: the trailer weight is referred to the basic unit without options and accessories.

ITRunner

ITR 10.16T
TELESCOPICO





ITRunner

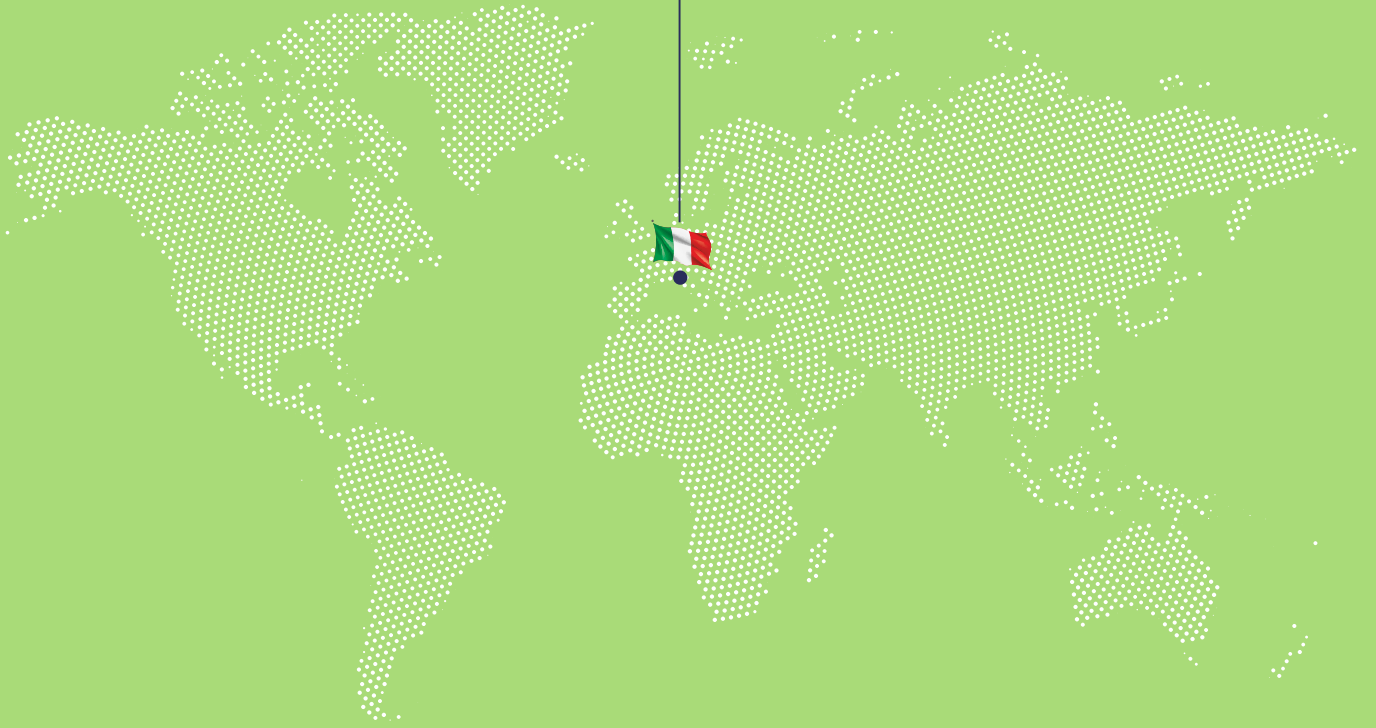

ITRunner

Reg. Oltre Rea, 32
12060 Monchiero (CN) - Italy
Phone +39 0173 780 002
Fax +39 0173 780 700
Email: info@itranner.it

www.itrunner.it



lift your life