



ITR20.24
TELESCOPIC



ITRunner



www.itrunner.it

2 AXLES HOOKLIFT ITR 20.24
TELESCOPIC
HYDRAULIC SUSPENSIONS

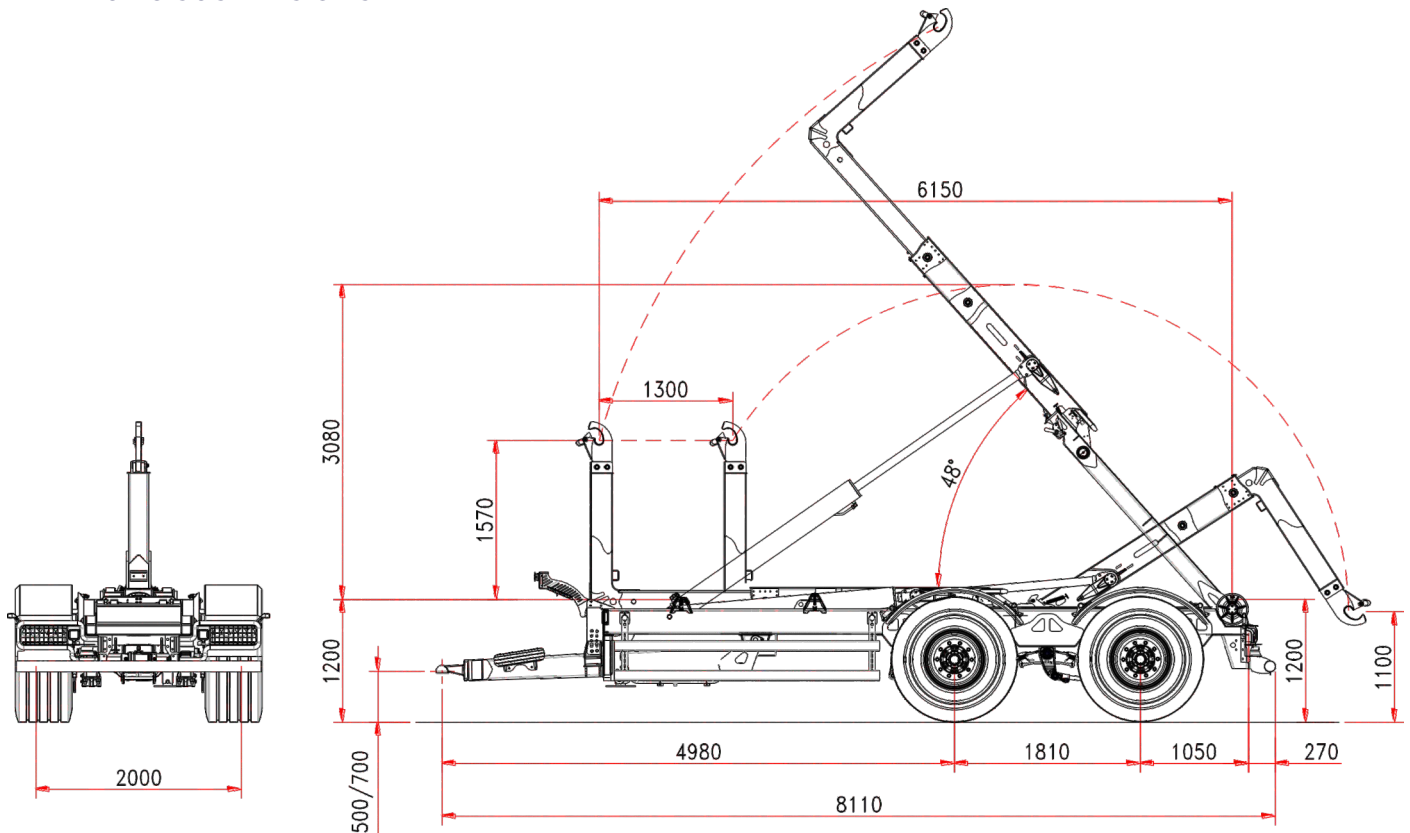

Standard Features

CHASSIS

Frame section	250 x 100 mm
Draw bar	silent block
Leaf spring suspension	24 t
Axles wheelbase	1810 mm
Axles section	2 x 110 mm
Axles	fixed + fixed
Track	2000 mm
Brake drums	406 x 120 mm
Braking system	hydraulic
Towing eye	turning
Support foot	1xhydraulic
Wheel size	550/60 R22,5
Chassis loading level	1200 mm
Front stab. cilinder 3rd point	optional

WEIGHT AND DIMENSION

Gross Trailer Weight (G.T.W.)	24 t
Container handling cap.	5500/7000 mm
Max speed	40 km/h
(*) Tare	6300 kg

TELESCOPIC ARM

Run	1300 mm
Hook level	1425/1460/1570
Container internal/external locking	hydraulic
Tipping angle	48°
Hoist start cylinder	standard
Tipping capacity**	22 t
Lifting capacity**	20 t

**They may vary according to the type of tire and the pressure provided by the tractor

OLEO-DYNAMIC SYSTEM

Tractor hydraulics	1 controls d.a.
Oil volume (hooklift filled)	50 l
Hooklift filled:	
Cylinders oil operation demand	19 l
Tipping	22 l
Loading/unloading	180/200 bar
3 sections electro-valves with control Bobeasy base	

(*) Tare: the trailer weight is referred to the basic unit without options and accessories.

ITRunner

ITR 20.24
TELESCOPIC





ITRunner

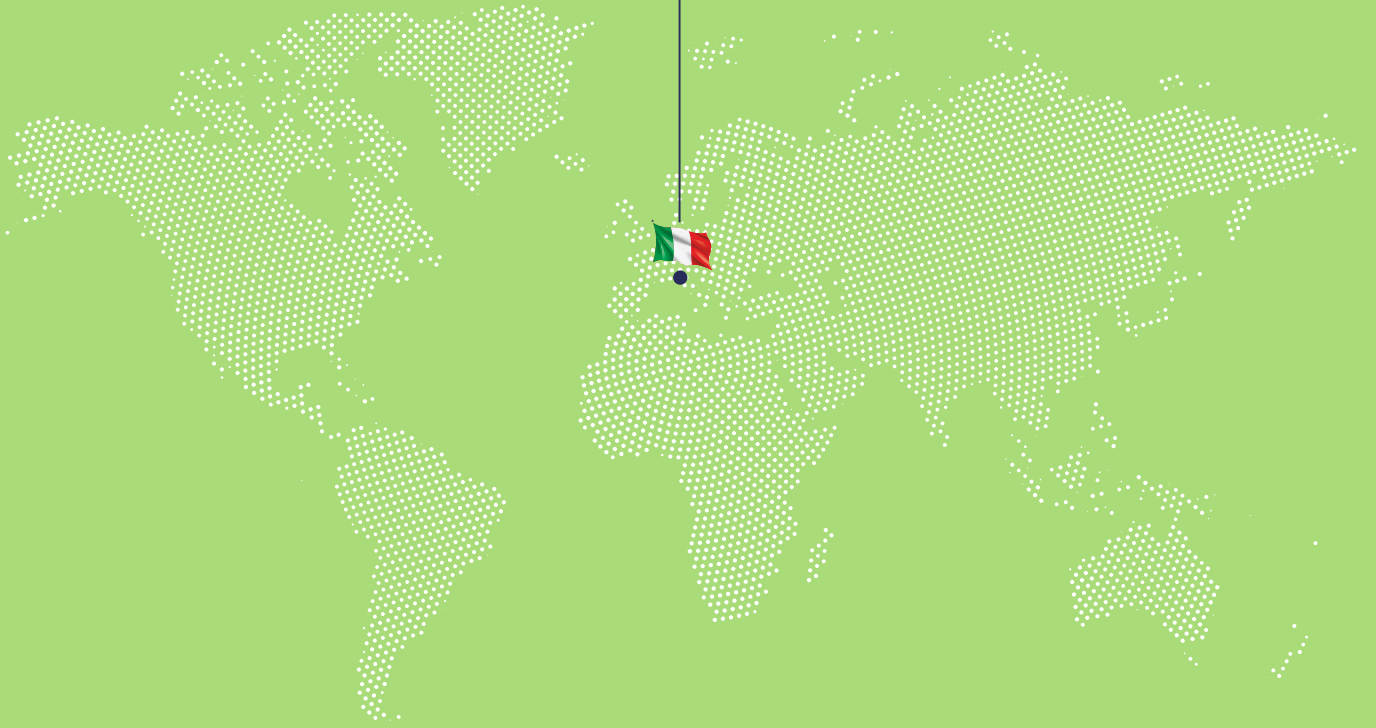

ITRunner

Reg. Oltre Rea, 32
12060 Monchiero (CN) - Italy
Phone +39 0173 780 002
Fax +39 0173 780 700
Email: info@itranner.it

www.itrunner.it

